



# North Borneo

CRUISES

BUSINESS | ENTERTAINMENT | LEISURE

KOTA KINABALU, SABAH, MALAYSIAN BORNEO

PRODUCT OVERVIEW



BUSINESS | ENTERTAINMENT | LEISURE

## Introducing Sabah's **Premier Dining Cruise**

Poised between a dramatic mountain range and a coastline overlooking the jungle-clad islands of a protected marine park, the state capital of Sabah is a laid-back coastal city we find best admired from the water. Get a feel of Kota Kinabalu's stunning sea-side position with a combination of sumptuous cuisine, breezy sea views and live music onboard the North Borneo Cruise.

First of its kind in Sabah, the North Borneo Cruise takes you on a 2-hour scenic cruise past the islands of Tunku Abdul Rahman Marine park and down the central coast gliding along the city's famous Waterfront for a truly sun-sational evening.







Fiery Scenery



Sunset Point

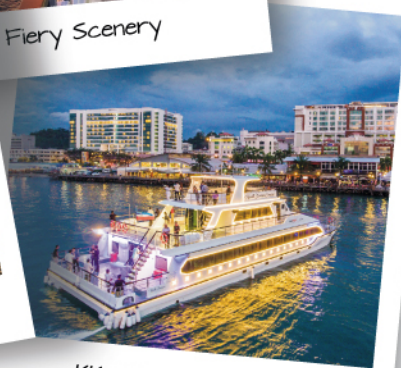

KK City Waterfront

## SUNSET DINNER CRUISE & KK CITY WATERFRONT NIGHT CRUISE ROUTE

### IMPORTANT NOTICE

The management reserve the right to change the cruise route without prior notice in the case of bad weather or sea conditions.

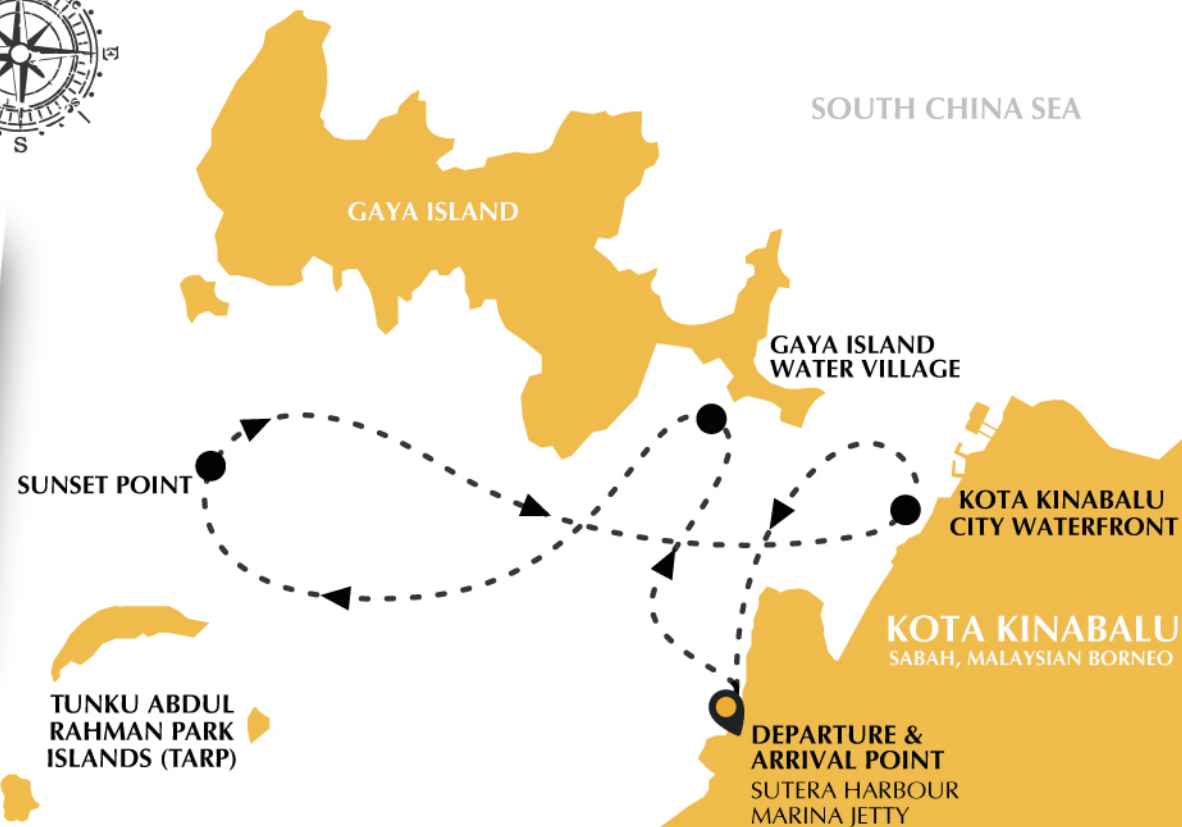

# PICTURE GALLERY

---

*North Borneo*  
CRUISES



UNFORGETTABLE VIEWS



# CRUISE OVERVIEW

*North Borneo*  
CRUISES

**Maximum Capacity** 100 pax per session

**Daily Departures** Sunset Dinner Cruise | 5.30pm - 7.30pm  
(Approximately 2 hours)

KK City Waterfront Night Cruise | 8.00pm - 9.30pm  
(Approximately 1.5 hours)

**Cruise Route** Cruise along Tunku Abdul Rahman Park Islands  
and KK City Waterfront

**Inclusions** International Buffet Dinner (Sunset Dinner Cruise) /  
Light Refreshments (KK City Waterfront Night Cruise)  
+ Live Band Entertainment

**Private Functions** We cater for Private Events and functions including  
(Between 8am-11pm) Weddings, Birthdays, Themed Parties, Anniversaries,  
Corporate Events, Gala Dinners, and more.





# FOR ANY OCCASION

*North Borneo*  
CRUISES

**A unique location for a truly memorable occasion.** Build to accommodate up to 100 pax per session, the gracefully designed vessel makes for the perfect venue to host a multitude of events at sea. Celebrate special moments on our stylish upper sun-deck, propose to someone out at sea as the sun goes down or host an unforgettable private-chartered event for the whole office. For an extra bit of exclusivity, the VIP Deck boasts a private room equipped with a Karaoke audio and visual sound system best suited for birthday parties and business meetings of up to 30 people. The interior remains true to its North Bornean roots. tribal décor accentuates the ambience with intrigue and vibrancy, at the same time showcase the traditional handloom weaving skills of North Borneo's indigenous Rungus Tribe.

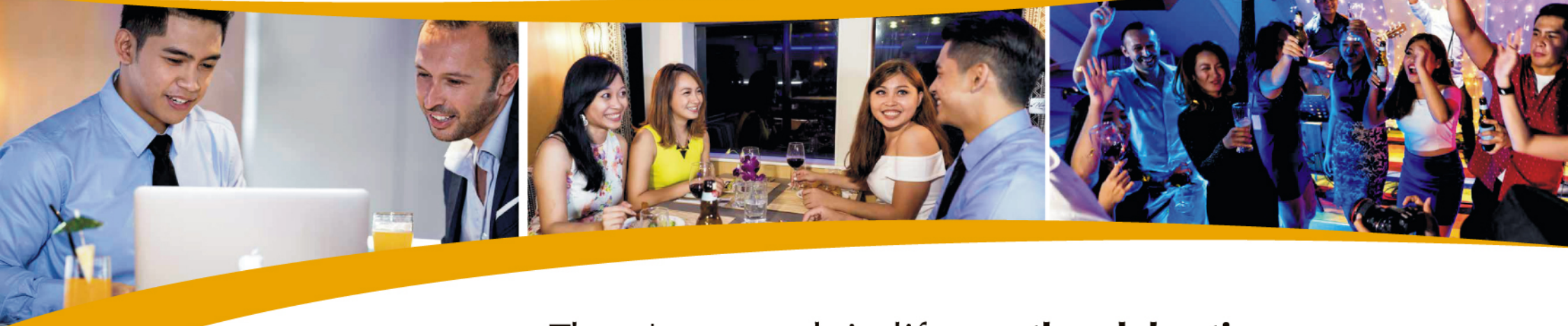

There's so much in life **worth celebrating.**  
You can start with **our stunning venue...**



# PICTURE GALLERY

---

*North Borneo*  
CRUISES



UNFORGETTABLE VIEWS

# PICTURE GALLERY

*North Borneo*  
CRUISES



LEVEL 3 - SUN DECK

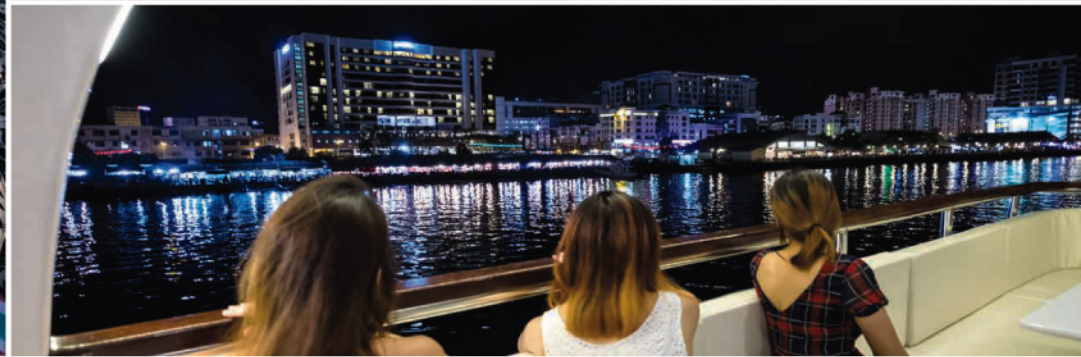



# BUSINESS

*North Borneo*  
CRUISES

**There is no better way to seal the deal.** Impress your client with a memorable experience paired with impeccable service, sumptuous buffet dining and spectacular views. Our sleek vessel is built with a VIP Karaoke room, Hi-res PA system, elegant terraces and upper-deck lounges to suit every meeting objective.

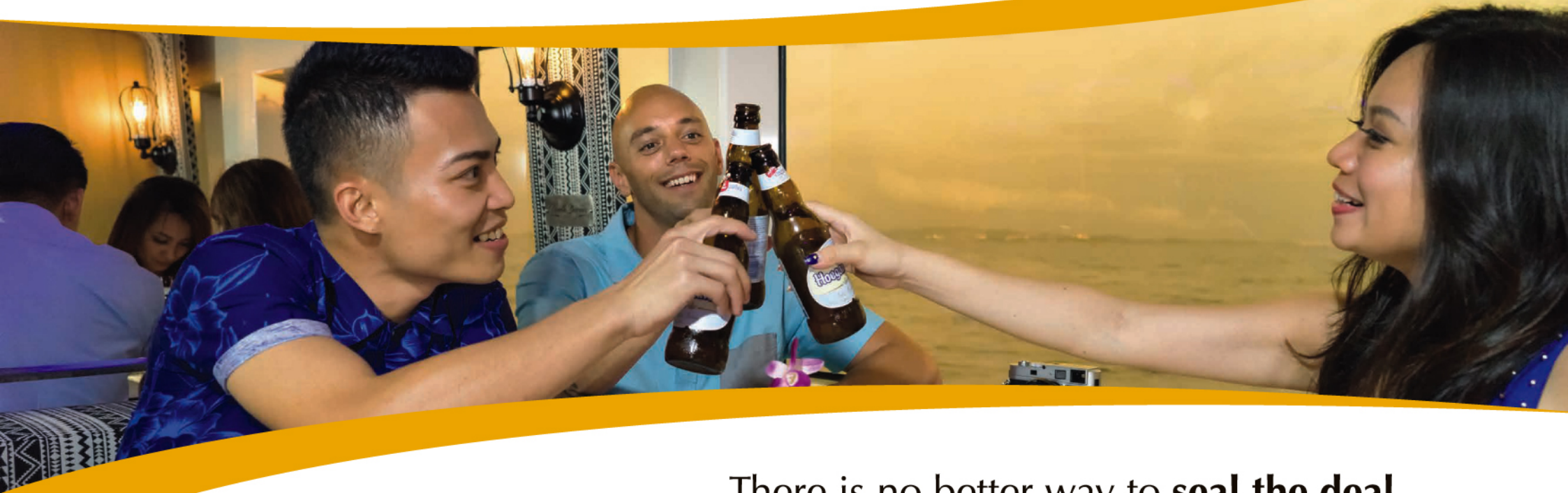

There is no better way to **seal the deal...**

# ENTERTAINMENT

*North Borneo*  
CRUISES

On the main deck, an air-conditioned—fully enclosed and unimpeded by weather—buffet dining area combines sightseeing with on-stage live performances. Large windows framing the scenic allure of nature on the outside isn't the only thing that commands attention. Front and center, an intimate platform stage with quality entertainment tempts diners to let loose on the dancefloor. On weekends, a Bamboo Orchestra brings forth the sounds of Borneo through a palette of unique bamboo instruments.



Breezy ocean views await you on the sun-deck.  
.... Live music & fun times await you on the dance floor.



# PICTURE GALLERY

*North Borneo*  
CRUISES



LEVEL 2 - VIP ROOM



# PICTURE GALLERY

*North Borneo*  
CRUISES



LEVEL 1 - MAIN DECK (DINING AREA)



# LEISURE

*North Borneo*  
CRUISES

The dinner cruise fondly named 'Luna' makes the most of its ocean views by featuring a sun-deck that openly greets the gentle breeze of the South China Sea, along with what the city of Kota Kinabalu is most famous for, the blazing sunsets. The relaxed atmosphere extends to the spacious outer deck, complete with cozy open-sky seating for you to soak in glorious panoramic views of jungle-clad Tunku Abdul Rahman Marine Park islands and the sensational Kota Kinabalu coastline glistening after-dark.

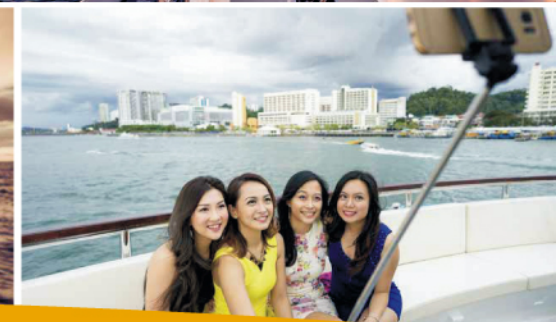
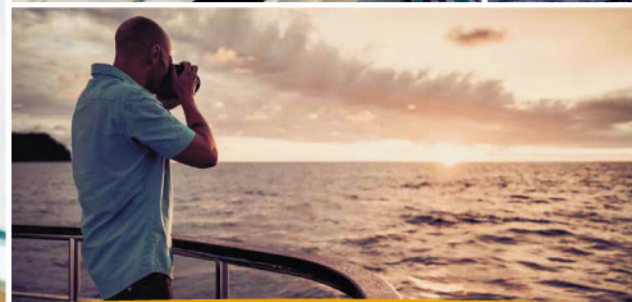



# PRIVATE CHARTER - DISTINCTLY DIFFERENT

*North Borneo*  
CRUISES

We cater for private events and functions including weddings, birthdays, themed Parties, anniversaries, corporate events, gala dinners, and more.





# WHY NORTH BORNEO CRUISES?



## **The one and only true dinner cruise in town**

An exquisite offering unlike any other. Being the first of its kind in Sabah, we're adding a whole new dimension to sightseeing in the charming coastal city of Kota Kinabalu.



## **A venue for all occasions**

Whether it's a birthday party or a wedding reception, North Borneo Cruises charters with facilities enough for 100 persons. You and your companions can have a world of your own within the catamaran.



## **Impeccable service & top safety standards**

Our high safety standards are just one of the many ways we put your mind at ease. The cruise is meticulously maintained and carefully checked between sessions by our team of dedicated deck-hands.



## **Highly maintained facilities**

All amenities are well preserved to ensure passengers have access to everything without any problem. Comfort and space all in one place.



## **Professional and friendly cabin crew**

North Borneo Cruises's cabin crew are well prepared to attend to your needs at any time. Our highly trained service crew ensure that you have a wonderful time, from the moment you step aboard until you disembark. So just sit back, relax, and have a jolly good time!

# OUR SAFETY PROCEDURES



At North Borneo Cruises, the safety and well-being of our valued passengers are our highest priorities. We are committed to providing you with an exceptional and worry-free experience on board. In strict compliance with international maritime regulations, we have implemented comprehensive safety procedures to ensure your utmost protection.

Our cruise will span approximately 2 hours, taking you on a journey across the captivating South China Sea, through the pristine Tunku Abdul Rahman Marine Park, and along the picturesque waterfront of Kota Kinabalu city. Before our ship sets sail, our highly trained crew will conduct a thorough safety briefing session, guiding you through essential safety procedures and emergency protocols. This ensures that you are well-prepared and confident right from the start of the cruise.

In the unlikely event of an emergency, our evacuation signal will consist of 7 short blasts followed by 1 long blast. Please pay close attention to any announcements made by our crew members, as they will provide crucial instructions to guarantee your safety.

Upon hearing the evacuation signal, please retrieve your life vest from the drawer beneath your seat. Proceed to the designated emergency staging area, known as the muster stations, as directed by our crew. Detailed instructions on how to properly wear your life vest, along with the locations of the muster stations, can be found in the diagram provided in the next page.

Your life vest is equipped with additional safety features to ensure your well-being. In the event of low air pressure, you can easily refill the vest by blowing into the mouthpiece. Furthermore, your life vest includes a whistle for attracting attention and a bright LED light that will automatically activate upon contact with water.

In the unfortunate event of smoke or fire, please remain close to the floor and move in a low crawl towards the nearest exit. Our emergency lights will automatically illuminate, guiding you towards the closest exit and the designated muster stations where you can gather with fellow passengers.

To maintain a safe environment for all guests, smoking on our cruise ship is strictly limited to designated area outside the restaurant. We kindly request that you refrain from disposing of cigarette butts, matches, or cigar ends over the side of the ship.

Rest assured that at North Borneo Cruises, we are fully dedicated to your safety and will spare no effort to provide you with a memorable and secure voyage. Please sit back, relax, and embark on an extraordinary journey with us.



# LIFE JACKET USAGE GUIDE AND EVACUATION PLAN

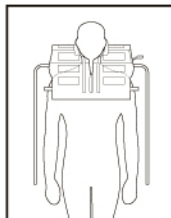

Place the lifejacket over your head.

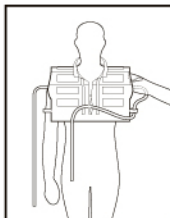

Take the strap from behind, bring it under your arm and insert it into both loops as shown above.

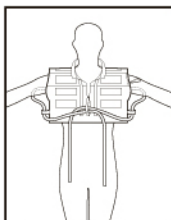

Repeat for both sides and ensure that both straps are under your arms and are secured correctly.

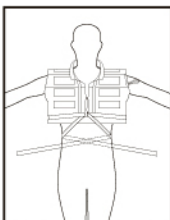

Wrap the strap around your waist once and pull the straps tightly around your waist.

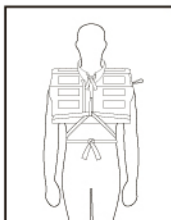

Tie the straps firmly at your waist then tighten and fasten the collar straps.

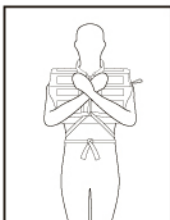

Before entering the water, hold both arms tightly to your chest.

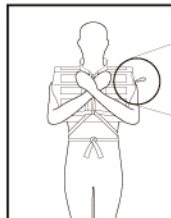

Every lifejacket is equipped with an emergency whistle which is located in the left shoulder pocket.



In case of emergency, use this whistle to call for help and attract attention.

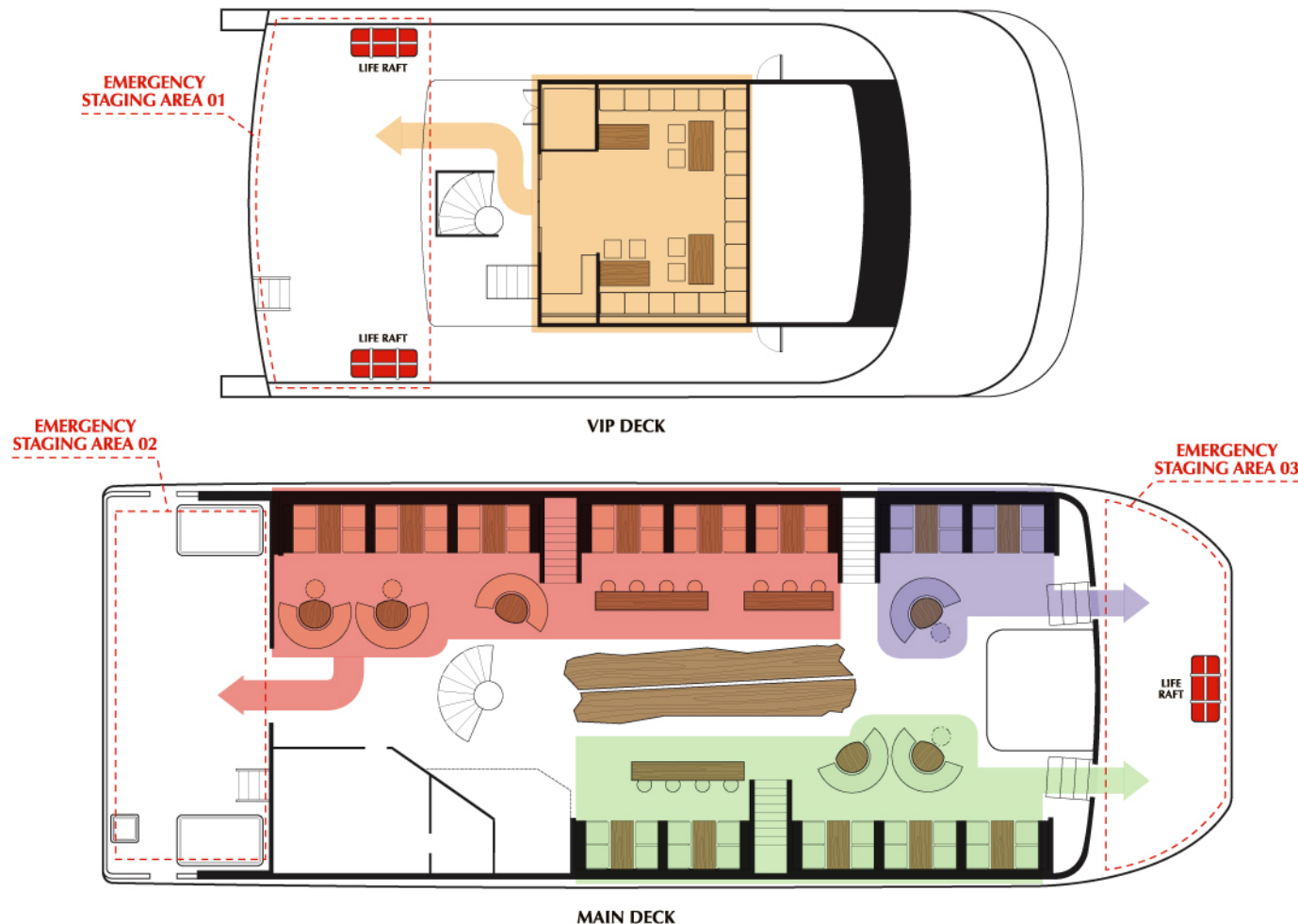

# North Borneo

## CRUISES

BUSINESS | ENTERTAINMENT | LEISURE

KOTA KINABALU, SABAH, MALAYSIAN BORNEO

[www.NorthBorneoCruises.com](http://www.NorthBorneoCruises.com)

L1.34, 1st Floor, Kompleks Asia City, Jalan Asia City, 88000 Kota Kinabalu, Sabah, Malaysia.

+6 088 448 409 +6 018 666 2009 | +6 017 933 3696  [info@northborneocruises.com](mailto:info@northborneocruises.com)    northborneocruises